

Edcor

Class X

XS4400 & XS4401

12 Pin PCB Mounted Transformer

Pin 1 is offset for keying.
Pad should be at least 150 mil. dia.
Holes should be 55 mil. dia.
after 2 oz. copper plated though.

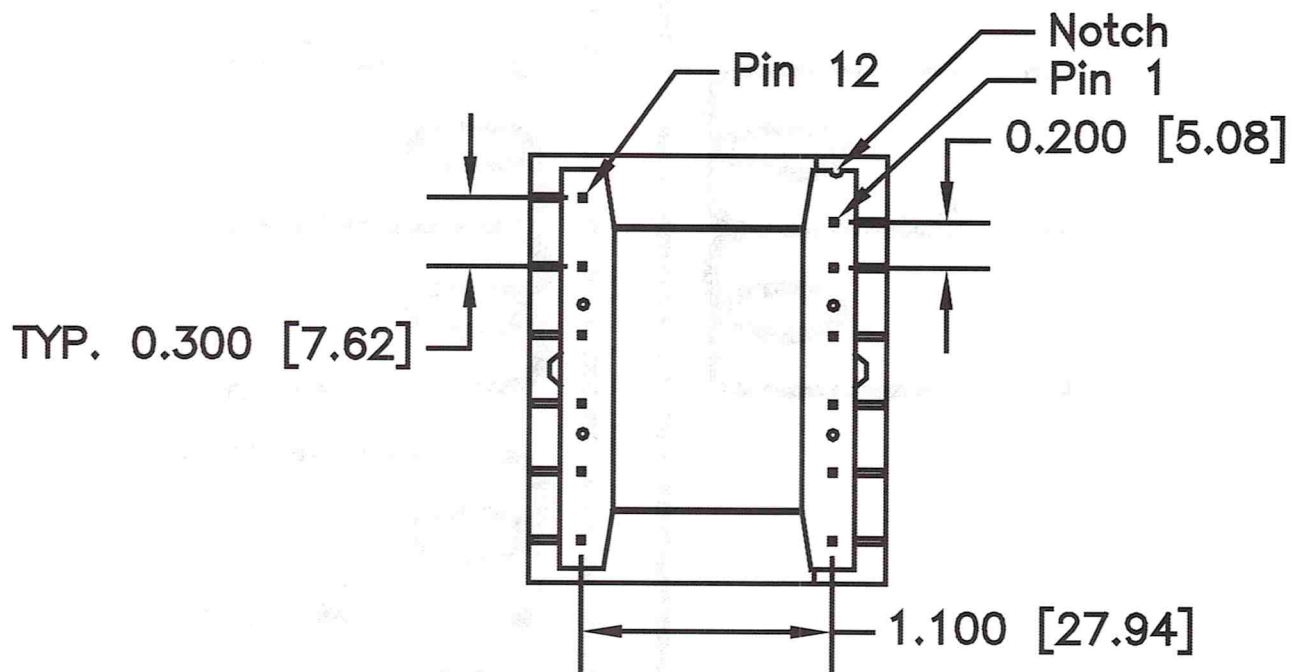

www.edcorusa.com

EDCOR Electronics Corporation
7130 National Parks Highway
Carlsbad, NM 88220
U.S.A.
(575) 887-6790

Edcor

Class X

XS4400 & XS4401

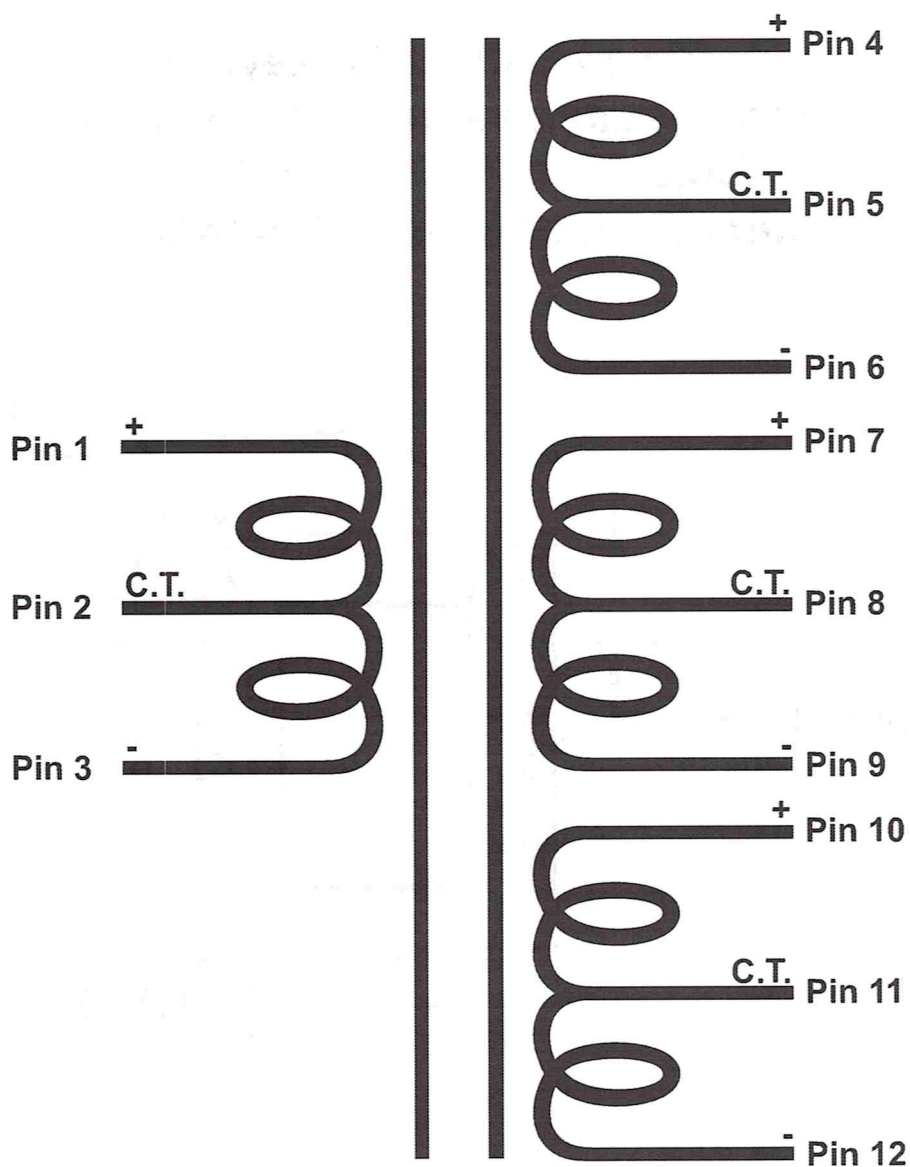

www.edcorusa.com

EDCOR Electronics Corporation
7130 National Parks Highway
Carlsbad, NM 88220
U.S.A.
(575) 887-6790

✓RoHS
✓REACH